



Special Report

Prop. W & Measure E Update

WISEBURN SCHOOL DISTRICT www.wiseburn.k12.ca.us 13530 Aviation Boulevard Hawthorne, California 90250-6498



At the new Juan de Anza, sounds of construction have been replaced by the recital of ABCs, as students, teachers and school personnel begin their first full school year in the new building. Commemorating this historic move is a Grand Opening celebration on October 26 to welcome community members, alumni and former employees into the new facility.



A curved steel canopy and angled walls create a welcoming space in the main entranceway.

Research shows certain color schemes can positively influence students' attitudes, behaviors and learning. Bright, primary colors are everywhere - hallways painted with red, blue and yellow; vibrantly colored outdoor trellis work and colorful flooring tile throughout the building: from "wet" work areas in classrooms, to the teachers' workroom, and the multi-purpose center. Anza incorporates playful elements designed to stimulate the kids, and enhance the learning environment.

The 1:30 p.m. dedication ceremony at Anza (12110 S. Hindry Avenue) includes docent-led building tours, student entertainment and refreshments.

Better Design

The new 62,000 square foot facility is nearly a 70 percent increase in square-footage. The school's U-shape layout creates small communities of learning, while encouraging both indoor and outdoor student activities. With a pre-K center, two daycare rooms, 28 K-5 classrooms, kitchen, library/media center and multi-purpose center, the new building is a learning facility and a community resource.



Trellis work protects double glazed window, and adds a distinctive look to Anza.



Kindergarten classrooms are large at 1300 sq. ft.

Large classrooms range from 1,000 square feet in the south wing to nearly 1,300 square feet in the kindergarten rooms. Each room has built-in base cabinets with adjustable upper shelves, white boards on sliding tracks, a sink and formica countertops.

21st Century Technology

A state-of-the-art technology package has been created for Anza's students, teachers and staff. The new technology supports teachers in curriculum development, enhances student learning and facilitates administrative tasks.

Centrally located, the library/media center is the hub of an extensive computer and video network. This network allows synchronized video capability across all classrooms, as well as Internet and Intranet resources.

The design creates unique spaces by using materials that reflect the region's emphasis of high-tech industries. The structural system uses exposed structural steel members such as large steel bow trusses over the entry and exposed steel tube canopies at the building's exterior. The steel connections provide detail and playfulness, using column exposures and brightly colored finishes.

Energy Efficient

At Anza, energy efficient measures contribute to an enjoyable environment for the kids, and a potential cost savings for the District. The school's design maximizes indirect daylight through the use of clerestory windows with "pop ups" in the hallways, as well as the tinted (Solar Green) double glazed windows in the classrooms. Classroom wings are oriented east and west to provide maximum solar orientation and to minimize the noise impact of the freeway. Energy-efficient T-8 lighting is also used. T-8 emits less heat, allows for better lighting distribution and uses less electricity. The use of indirect daylight offers students a naturally-lit, comfortable learning environment and has another advantage—it can potentially decrease electricity bills.

Energy efficient materials used for Anza's construction include R-19 and R-30 insulation, and single-ply roofing. These materials maintain a comfortable environment by reducing the amount of heat—or cold—penetrating the building from the outside, as well as reducing the amount of heat—or air conditioning—that escapes to the outside. The heating and air-conditioning (HVAC) system has energy efficient temperature controls such as using separate time clocks for specific areas (multi-use, administration, kindergarten, etc.); a manual override that allows efficient conditioning of various zones; and "economizer" controls that use outside air for 100 percent ventilation cooling when temperatures are mild. Anza also has an emergency generator as insurance against power outages.

continued from page 1

All classrooms, the library/media center and the teachers' lounge have 32" television monitors for use with a Safari digital video content system. Using this system, teachers can access video content for all curricular areas (based on state and national standards). The system also allows for DirecTV access and the ability to digitize video from VHS format.



The large multi-purpose center will be available for after-hours use, making it a resource for both students and the community.

The technology package also includes 20 desktop computers and four look-up stations in the library/media center; six desktop computers in each classroom, and 30 wireless laptops (to reduce the student-to-computer ratio during class project work involving technology).

Anza and the Community

From the onset, the District planned the new school as both a state-of-the-art learning center for students and a community resource. Skewed at a 45 degree angle, the multi-purpose center is located at the northwest corner of the campus where it is easily accessible. Planned for after-hours use, the center—including a stage, kitchen, restrooms and Eagle Center room—can be closed off from the main part of the school, making it convenient and safe for community use. A lighted soccer/softball field will also be available, by permit from the District, in the future.



Colorful areas outside the kindergarten classrooms create a distinct space for the smallest students.

It's all About the Kids

At Wiseburn, it's all about the kids and Anza is proof positive. The new building reinforces to students that they are what matters, and that their education and success is important!

Thanks to the community's approval of Proposition W and Measure E, we have a wonderful new Anza School (and we're working on plans for two more new schools in the future). We hope you'll be able to join us as we celebrate Juan de Anza Elementary School's Grand Opening.



The main entranceway uses curved steel columns and bold colors to create a playful space.

Building Plan Chosen for "South Side" Schools

For the past two years, Wiseburn has been evaluating how best to reconstruct its elementary and middle school in HollyGlen. There have been "town hall" meetings, Board meetings, faculty meetings, homeowners meetings, surveys, newsletter articles, and televised interviews to discuss building new Cabrillo and Dana schools. The Board has now reached a decision and the Big Bold Baby Blue Plan is it.

THE BIG BOLD BABY BLUE PLAN

This is a huge (big) investment in the community. It's aggressive (bold) in scope. It combines the scheme from the blue option with the simultaneous construction offered by the white building option (mix blue with white and get, baby blue) into a winning solution.

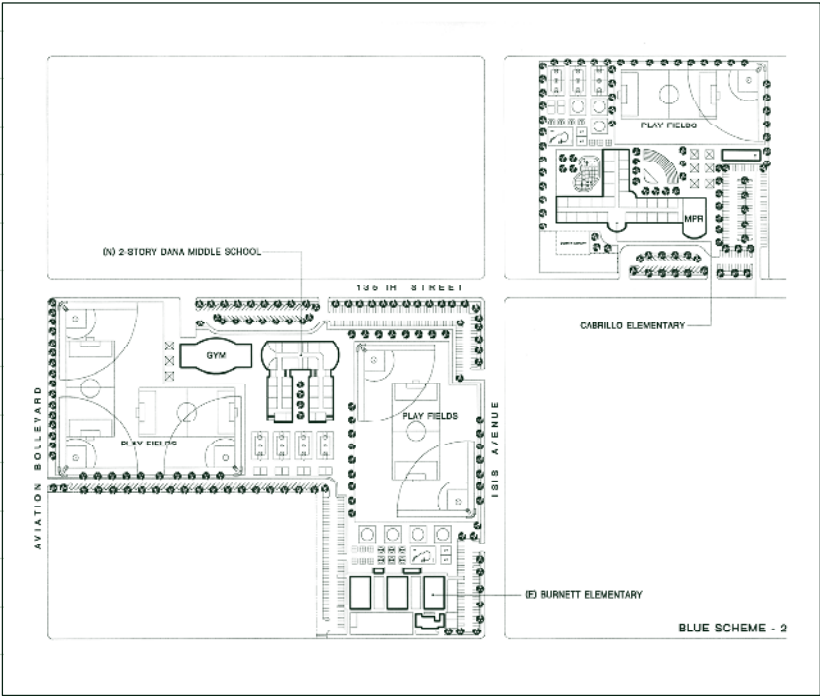

***The exact locations of the schools shown will not necessarily be the final footprint.*

With the baby blue plan a new K-2, or K-3, Cabrillo School will be built on the current Cabrillo site, and a new Dana Middle School (6-8) will be built on 135th street, east of the current school site. The exact footprints of each campus are being decided. Both schools will be built simultaneously. Construction on both schools should be complete by the fall of 2006. A new district office, maintenance/warehouse site will also be needed.

CABRILLO ELEMENTARY SCHOOL

The new Cabrillo will be nearly 60,000 square feet with pre-kindergarten space, 18-22 kindergarten and primary

classrooms, four special education classrooms, a library, kitchen and multi-purpose room with a stage.

DANA MIDDLE SCHOOL

The new Dana Middle School will be approximately 76,000 square feet, and will include 24 classrooms, two special education classrooms, two resource rooms, a multi-purpose room with a stage, a kitchen, two science labs, an art lab, tech lab, library, locker rooms and a gym.

continued on page 4

Advantages of the "Big Bold Baby Blue" Plan

- ✓ Both schools are completed sooner, resulting in a shorter overall construction period
- ✓ Preserves small enrollment schools
- ✓ Puts schools on adequate sized sites
- ✓ Added leverage: the larger bid of \$30+ million for both schools will attract better contractors
- ✓ Saves money—by building both schools at the same time:
 - ✓ both bids are made sooner, avoiding rising costs caused by inflation
 - ✓ potential to earn "economies of scale" by simultaneous construction

Construction Overview

Several factors were taken into consideration when deciding on a plan to build the two schools simultaneously.

— SPACE

As the two new schools are built, additional classrooms will be included to allow increased enrollment. The challenge then is how to move the additional Cabrillo (K-2) students through Burnett (3-5) to Dana (6-8). One solution is to build enough Cabrillo classrooms, perhaps 35, so that third grade could be moved to Cabrillo. Burnett would then become a 4-5 grade school—the current third grade classrooms would house the additional fourth and fifth graders. Another option is to supply six more classrooms at Burnett and keep the grades at the two schools the same.

— TRAFFIC

A comprehensive traffic study, including public hearings, will be an integral part of the solution. Anticipated issues, including the exact footprint for each school, will be mitigated.

— COMMUNITY FIELD USE

There will most likely be one more baseball season and two more soccer seasons before the Cabrillo and Dana fields are closed to the community. Sadly, the fields will be lost for at least two years. In the meantime, volunteer leaders will be looking for other fields to use. The good news is the fields will be wonderful and new when they reopen after construction.

— DISTRICT OFFICE/MAINTENANCE/ WAREHOUSE

These facilities will need to be housed off the school sites. This move will most likely need to occur in 2004 since the existing maintenance/warehouse will be in the way of construction. A lease/purchase arrangement in eastern El Segundo is recommended by the District. (Note: Wiseburn's western boundary is Sepulveda.)

Mark Your Calendar - Supt's On!

On Tuesday, October 15, 2002 from 7-9 p.m. Dr. Don Brann will hold informal, individual meetings with parents and community members at the Wiseburn District Office (13530 Aviation Blvd.) in Hawthorne. Dr. Brann will be available to discuss topics of your

request and is open to public input. Sessions are limited to 20 minutes. Interested people are urged to call Julie Babineau at 310.643.3009 to make an appointment. Drop in visitors will be worked into the schedule if time is available.

WISEBURN SCHOOL DISTRICT
13530 Aviation Boulevard
Hawthorne, California 90250-6498

Non-Profit
U.S. Postage
PAID
Permit No. 62
Hawthorne, CA

BOARD OF TRUSTEES
Dennis Curtis, President
Marta Chelero, Clerk
Jo Anne Kasper, Member
Betsy West, Member
Linda Wong, Member
Superintendent
DR. DON BRANN